

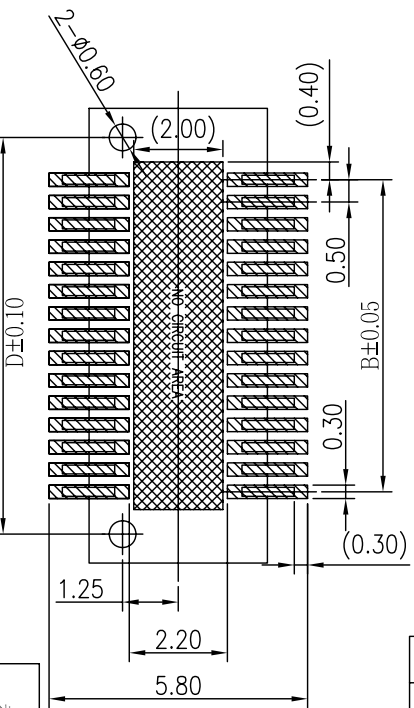

NOTES:  
 1.HOUSING: PA9T HIGH-TEMP THERMOPLASTIC UL94V-0 COLOR:BLACK  
 2.TERMINAL:PHOSPHOR BRONZE  
 PLATING:1" GOLD FLASH OVERALL 50~100;" NICKEL UNDER PLATED.

Ordering information

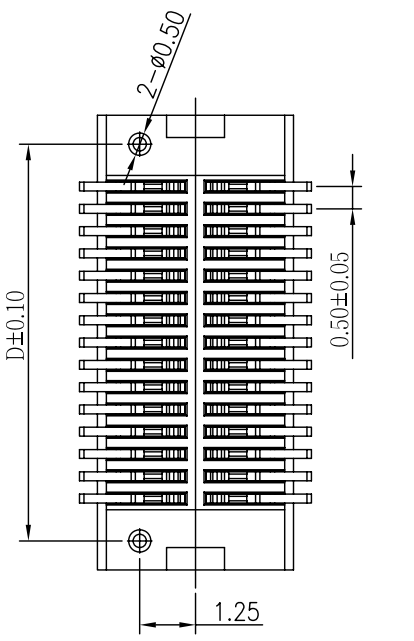
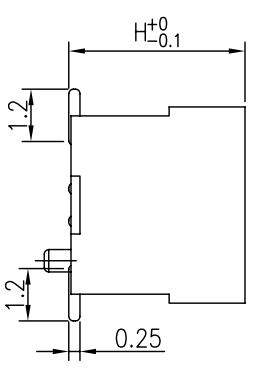
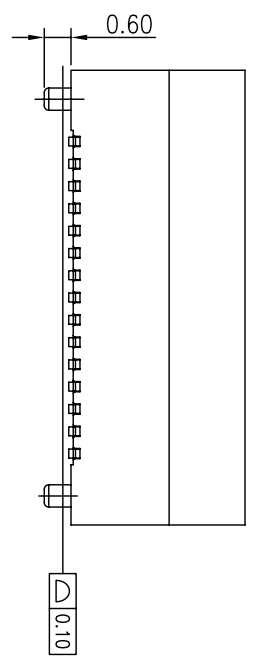
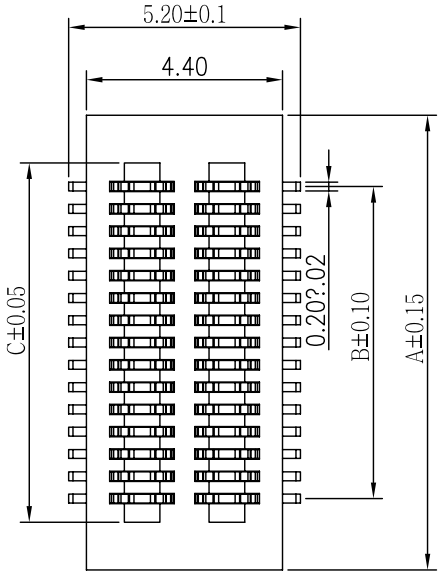
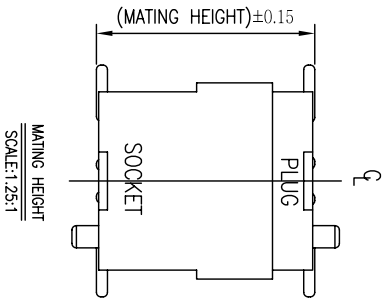
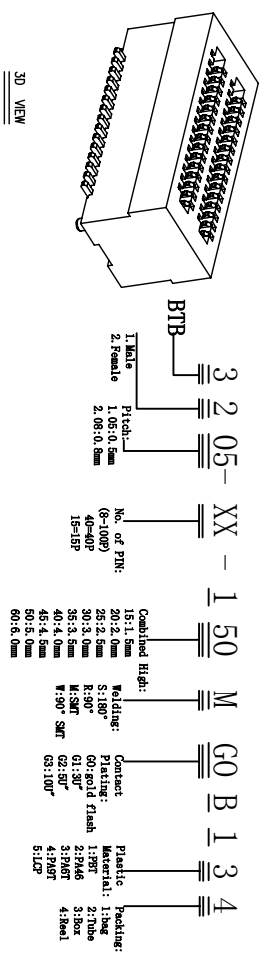

RECOMMENDED PCB PATTERN DIM.  
 TOLERANCE : ±0.05

| MATING HEIGHT (H) | PLUG (H) | SOCKET (H) | NO. of contacts | Dimensions |       |       |       | NO. of contacts | Dimensions |       |       |       |
|-------------------|----------|------------|-----------------|------------|-------|-------|-------|-----------------|------------|-------|-------|-------|
|                   |          |            |                 | A          | B     | C     | D     |                 | A          | B     | C     | D     |
| 3.0               | 0.8      | 2.2        | 4               | 3.70       | 0.50  | 1.56  | 2.40  | 54              | 16.20      | 13.00 | 14.06 | 14.90 |
| 3.5               | 1.3      | 2.2        | 6               | 4.20       | 1.00  | 2.06  | 2.90  | 56              | 16.70      | 13.50 | 14.56 | 15.40 |
| 4.0               | 1.0      | 3.0        | 8               | 4.70       | 1.50  | 2.56  | 3.40  | 58              | 17.20      | 14.00 | 15.06 | 15.90 |
| 4.5               | 1.0      | 3.5        | 10              | 5.20       | 2.00  | 3.06  | 3.90  | 60              | 17.70      | 14.50 | 15.56 | 16.40 |
| 5.0               | 1.0      | 4.0        | 12              | 5.70       | 2.50  | 3.56  | 4.40  | 62              | 18.20      | 15.00 | 16.06 | 16.90 |
| 5.5               | 1.0      | 4.5        | 14              | 6.20       | 3.00  | 4.06  | 4.90  | 64              | 18.70      | 15.50 | 16.56 | 17.40 |
| 6.0               | 2.0      | 4.0        | 16              | 6.70       | 3.50  | 4.56  | 5.40  | 66              | 19.20      | 16.00 | 17.06 | 17.90 |
| 6.5               | 2.0      | 4.5        | 18              | 7.20       | 4.00  | 5.06  | 5.90  | 68              | 19.70      | 16.50 | 17.56 | 18.40 |
|                   |          |            | 20              | 7.70       | 4.50  | 5.56  | 6.40  | 70              | 20.20      | 17.00 | 18.06 | 18.90 |
|                   |          |            | 22              | 8.20       | 5.00  | 6.06  | 6.90  | 72              | 20.70      | 17.50 | 18.56 | 19.40 |
|                   |          |            | 24              | 8.70       | 5.50  | 6.56  | 7.40  | 74              | 21.20      | 18.00 | 19.06 | 19.90 |
|                   |          |            | 26              | 9.20       | 6.00  | 7.06  | 7.90  | 76              | 21.70      | 18.50 | 19.56 | 20.40 |
|                   |          |            | 28              | 9.70       | 6.50  | 7.56  | 8.40  | 78              | 22.20      | 19.00 | 20.06 | 20.90 |
|                   |          |            | 30              | 10.20      | 7.00  | 8.06  | 8.90  | 80              | 22.70      | 19.50 | 20.56 | 21.40 |
|                   |          |            | 32              | 10.70      | 7.50  | 8.56  | 9.40  | 82              | 23.20      | 20.00 | 21.06 | 21.90 |
|                   |          |            | 34              | 11.20      | 8.00  | 9.06  | 9.90  | 84              | 23.70      | 20.50 | 21.56 | 22.40 |
|                   |          |            | 36              | 11.70      | 8.50  | 9.56  | 10.40 | 86              | 24.20      | 21.00 | 22.06 | 22.90 |
|                   |          |            | 38              | 12.20      | 9.00  | 10.06 | 10.90 | 88              | 24.70      | 21.50 | 22.56 | 23.40 |
|                   |          |            | 40              | 12.70      | 9.50  | 10.56 | 11.40 | 90              | 25.20      | 22.00 | 23.06 | 23.90 |
|                   |          |            | 42              | 13.20      | 10.00 | 11.06 | 11.90 | 92              | 25.70      | 22.50 | 23.56 | 24.40 |
|                   |          |            | 44              | 13.70      | 10.50 | 11.56 | 12.40 | 94              | 26.20      | 23.00 | 24.06 | 24.90 |
|                   |          |            | 46              | 14.20      | 11.00 | 12.06 | 12.90 | 96              | 26.70      | 23.50 | 24.56 | 25.40 |
|                   |          |            | 48              | 14.70      | 11.50 | 12.56 | 13.40 | 98              | 27.20      | 24.00 | 25.06 | 25.90 |
|                   |          |            | 50              | 15.20      | 12.00 | 13.06 | 13.90 | 100             | 27.70      | 24.50 | 25.56 | 26.40 |

未注公差  
 UNLESS OTHERWISE  
 SPECIFIED TOLERANCE

Boxcom

TOLERANCE : ±0.05

一般公差  
 GENERAL TOLERANCE  
 A ±0.25  
 .XX ±0.15  
 .XXX ±0.05  
 ANIMS ±1

料号(PART NO.): 3205-XX250MGOB134  
 比例(SCALE): 1:8  
 单位(UNITS): 张数(SHEET)  
 1 OF 1  
 图幅(SIZE): A4

| 修订<br>REV | 修改摘要<br>REVISION DESCRIPTION | 签名<br>SIGNATURE | 日期<br>DATE |
|-----------|------------------------------|-----------------|------------|
|           |                              |                 |            |
|           |                              |                 |            |

RoHS  
 Compliant  
 2013/59/EC

PA9  
 Compliant

